

# New Product Bulletin



## S-DRIVE ELECTRONIC THROTTLE CONTROLLER



### WHAT IS AN S-DRIVE & HOW DOES IT WORK?

An S-Drive is an electronic throttle controller that works on modern vehicles that use "fly by wire" throttle technology, in other words, vehicles without an accelerator cable. Most fly by wire vehicles have a delay from the moment the accelerator pedal is pressed, to the time the signal gets to the throttle, otherwise known as "lag". The S-Drive reduces (and in some vehicles, eliminates) lag by giving you the ability to adjust the throttles sensitivity.

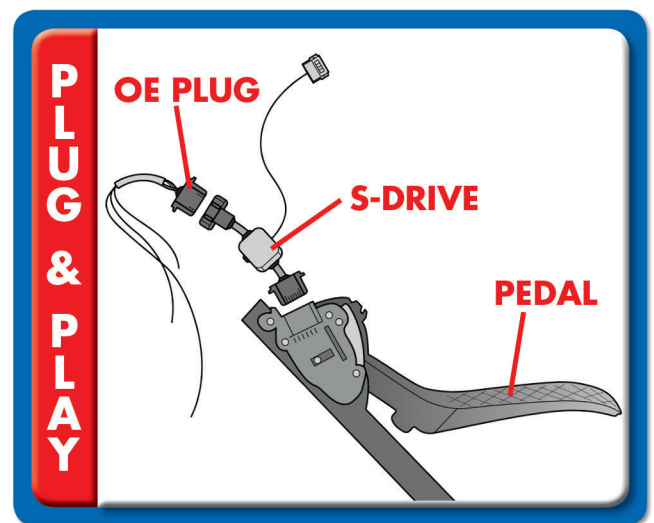

The S-Drive can be adjusted to suit any driving style with 5 DRIVING MODES to choose from, including:

- **COMFORTABLE MODE:** Designed for smooth acceleration. Adjustable sensitivity levels (1>9).
- **SPORTS MODE:** Improves the instantaneous acceleration. Adjustable sensitivity levels (1>9).
- **PERFORMANCE MODE:** This mode is designed for maximum acceleration. Adjustable sensitivity levels (1>9).
- **ECO FUEL SAVING MODE:** Designed for fuel saving with slower & smoother acceleration. Adjustable sensitivity levels (1>9).
- **ORIGINAL MODE:** In this mode the vehicle reverts back to the factory setting. Not Adjustable.

The S-Drive is a perfect fit for towing trailers, caravans or if you simply want to get better response out of your vehicle. The S-Drive suits all types of transmissions and petrol/diesel engines. In most cases, you can install the S-Drive in as little as 5 minutes with the help of the fitting guide.

- ✓ Plug & play technology. No wiring required
- ✓ Shortens response time between accelerator & throttle
- ✓ Perfect for towing as it gets you up to speed quicker



# New Product Bulletin

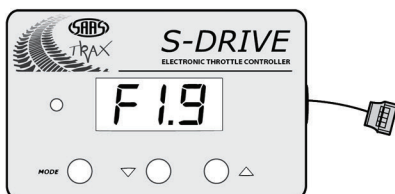

## S-DRIVE ELECTRONIC THROTTLE CONTROLLER

### FITTING GUIDE

MAKE	MODEL / SERIES	YEAR	ENGINES	PART NO.
Alfa	159	2006 -	All Engines	STC103
	Giulietta	2010 -	All Engines	STC103
Audi	A3	- 2004	All Engines	STC102
	A4	2000 - 2008	All Engines	STC102
	TT	- 2006	All Engines	STC102
	Q3	2012 -	All Engines	STC110
	Q5	2009 -	All Engines	STC110
BMW	All Models	2002 -	All Engines	STC112
Ford	Falcon (FG / FG-X)	2012 -	All Engines	STC102
	Everest	2011 -	All Engines	STC101
	Focus (CB8)	2011 -	All Engines	STC101
	Ranger (PX / PXII)	2011 -	All Engines	STC101
	Mustang	2011 -	All Engines	STC101
Holden	Colorado (RG)	2012 -	All Engines	STC103
	Colorado 7	2012 -	All Engines	STC103
	Commodore (VE)	2006 - 2013	All Engines	STC103
	Commodore (VF)	2013 - 2017	All Engines	STC104
	Cruze	2009 - 2014	All Engines	STC103
Isuzu	D-Max	2012 -	All Engines	STC105
	MU-X	2014 -	All Engines	STC105
LDV	LDV T60	2017 -	All Engines	STC116
	LDV D90	2017 -	All Engines	STC116
Mazda	6 (GJ / GL)	2012 -	All Engines	STC101
	BT-50 (UP)	2011 -	All Engines	STC101
	CX-3	2016 -	All Engines	STC101
	CX-4	2016 -	All Engines	STC115
	CX-5	2013 -	All Engines	STC115
	CX-9	2011 - 2016	All Engines	STC101
	CX-9	2016 -	All Engines	STC115
	ATENZA		All Engines	STC115
	MAZDA 3 AXELA		All Engines	STC115
	Mitsubishi	Challenger (PB / PC)	2008 - 2015	All Engines
Pajero (NS / NX)		2006 -	All Engines	STC106
Pajero Sport		2016 -	All Engines	STC107
Triton (MQ)		2015 -	All Engines	STC107
Triton (ML / MN)		2005 - 2014	All Engines	STC106

MAKE	MODEL / SERIES	YEAR	ENGINES	PART NO.
Nissan	Navara NP300	2015 -	All Engines	STC103
	Navara (D40)	2005 - 2015	All Engines	STC103
	Pathfinder (R51)	2006 - 2013	All Engines	STC103
	Patrol (GU / Y61)	2007 -	3.0L CRD	STC108
	Patrol (Y62)	2010 -	All Engines	STC103
	X-Trail	2008 -	All Engines	STC108
Subaru	Forester	2006 -	All Engines	STC111
	Impreza	2006 -	All Engines	STC111
	Liberty	2008 -	All Engines	STC111
	Outback	2008 -	All Engines	STC111
Suzuki	Grand Vitara	2006 -	All Engines	STC107
	Kizashi	2010 -	2.4L	STC106
	S-Cross	2013 -	All Engines	STC107
	Swift	2008 -	1.2 / 1.3 / 1.5	STC107
	Swift Sport	2006 - 2011	1.6 Petrol	STC109
Toyota	Sx4	2006 - 2008	All Engines	STC107
	Camry	2006 -	All Petrol Engines	STC105
	C-HR	2016 -	All Engines	STC105
	Corolla	2008 -	All Engines	STC105
	FJ Cruiser	2011 - 2016	All Petrol Engines	STC109
	Fortuner	2015 -	All Engines	STC105
	HiAce	2006 -	All Engines	STC109
	HiLux	2006 - 2016	All Engines	STC109
	HiLux	2015 -	All Engines	STC105
	LandCruiser(200 Series)	2007 -	All Engines	STC105
	LandCruiser	2007 - 2009	4.5L V8 Engine (76 / 78 / 79 Series v8)	STC109
	LandCruiser	2009 -	4.5L V8 Engine (76 / 78 / 79 Series)	STC105
	Prado (120 Series)	2005 - 2009	All Engines	STC109
	Prado (150 Series)	2009 -	All Engines	STC105
Rav 4	2005 -	All Engines	STC105	
Volkswagen	Amarok	2011 -	All Engines	STC102
	Beetle	2012 -	All Engines	STC110
	Golf IV	- 2004	All Engines	STC102
	Golf V / VI / VII	2004 -	All Engines	STC110
	Passat	- 2005	All Engines	STC102
	Touareg	2003 - 2010	All Engines	STC102
	Tiguan	2007 -	All Engines	STC110